

Exploded View

Tools Required for Assembly

- * 1/2" wrench (2)
- * Medium Size Adjustable Wrenches
or
- * Adjustable Wrench and set of open wrenches
- * Pair of pliers

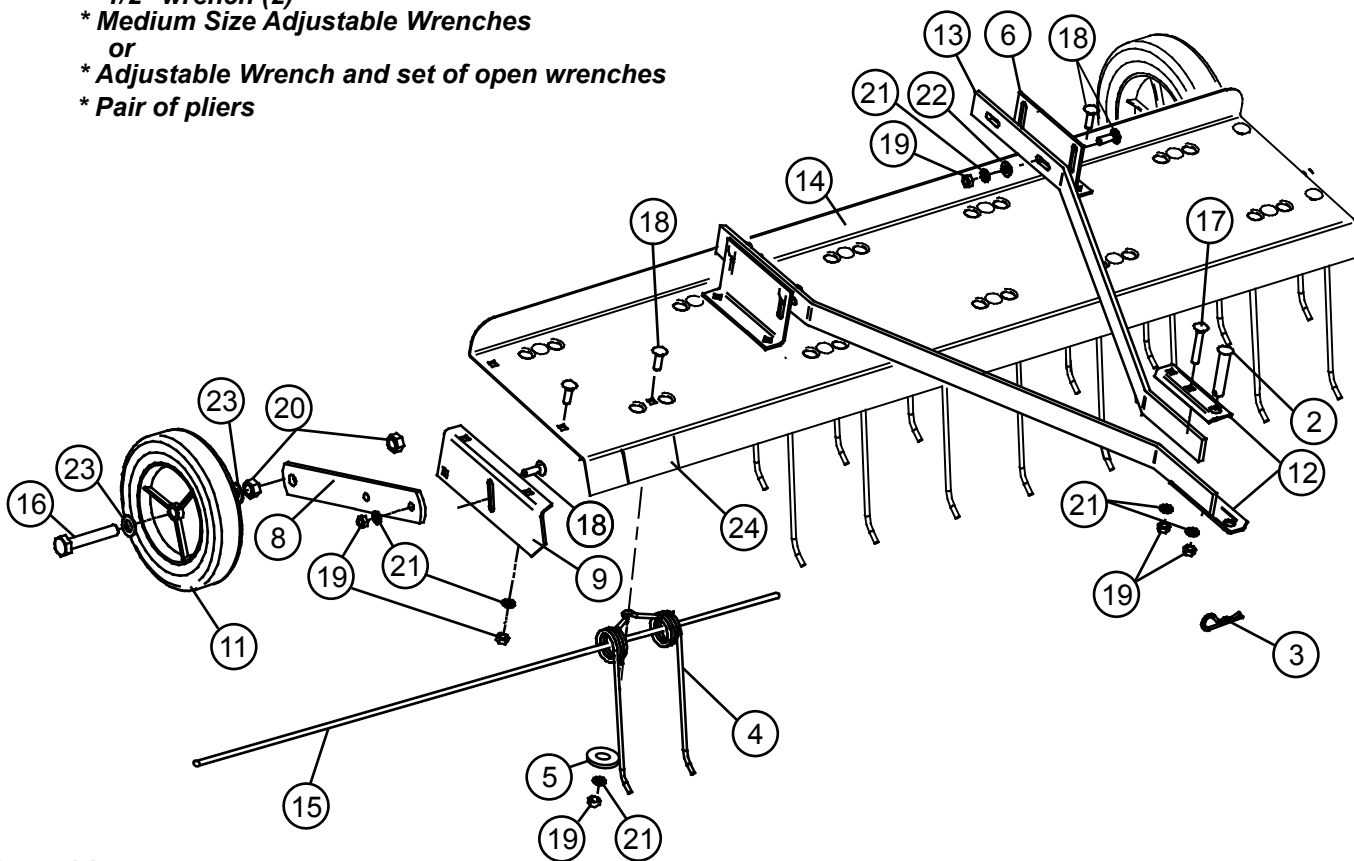

Parts List

REF. NO.	PART NO.	DESCRIPTION	QTY.
1	DT-48	Logo Decal	1
2	B-3686	Drawbar Pin	1
3	D-146P	Hairpin Cotter, 1/8"	1
4	R-616	Tine	12
5	R-618	Special Washer	12
6	R-713-10	Tray Mount Bracket	2
7	R-1541	Warning Decal	1
8	R-2479-10	Wheel Mount Bracket	2
9	R-889-10	End Plate (R.H.)	1
10	R-890-10	End Plate (L.H.)	1
11	R-891	Wheel	2
12	R-892-10	Clevis	2
13	R-1455-10	Pull Bar	2
14	R-1456-10	Tine Tray	1
15	R-1504	Safety Wire	2
16	1M1648P	Hex Head Bolt, 1/2" x 3"	2
17	10M1032P	Carriage Bolt, 5/16" x 2"	2
18	11M1016P	Carriage Bolt, 5/16" x 1"	28
19	30M1000P	Hex Nut, 5/16"	30
20	30M1600P	Hex Nut, 1/2"	4
21	40M1000P	Lock Washer, 5/16"	30
22	45M1111P	Flat Washer, 5/16"	4
23	45M1717P	Flat Washer, 1/2"	4

**INSTALLATION
QUESTIONS?
MISSING PARTS?
REPLACEMENT PARTS?**

**DON'T GO BACK
TO THE STORE!**

Please call our Customer Service
Department Toll-Free at
877.728.8224
or
[www.customerservice
@brinly.com](http://www.customerservice@brinly.com)

To Order Parts Call:
877-728-8224

Visit us on the web:
www.brinly.com